



"B15" RATED CLASS DOORS

AVAILABLE B15 RATED CLASS TYPES :

- SINGLE LEAF HINGED DOORS
- SINGLE LEAF SLIDING DOORS
- DOUBLE LEAF HINGED DOORS
- DOUBLE LEAF HINGED DOORS

AVAILABLE OPTIONALS :

- PORTHOLE
- RECTANGULAR WINDOW
- VENTILATION GRID
- PEEPHOLE
- KICK PLATE

PORTA CON TELAIO A "T"
 VISTA INTERNA - LATO CERNIERE

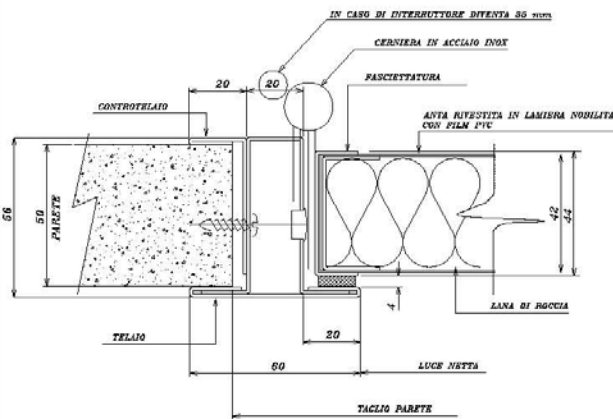
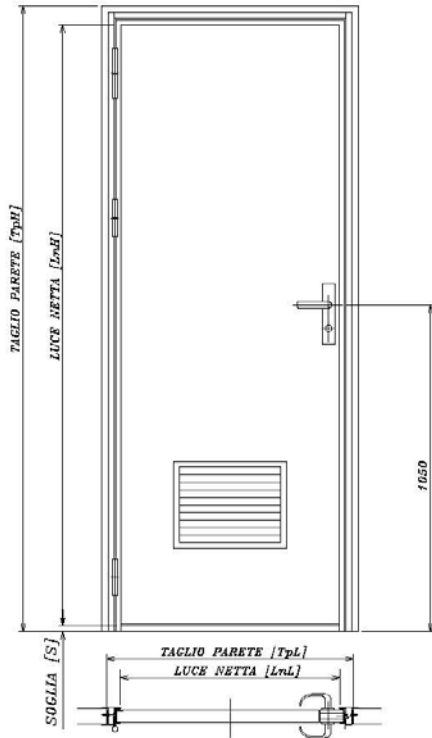

- FRAME STANDARD SECTIONS "T" AND "Z". CUSTOMIZED SHAPES AVAILABLE.
- FRAME FINISHING: STAINLESS STEEL, VARNISHED STEEL (RAL O NCS)
- 3 OR 4 STAINLESS STEEL HINGES (ONE WITH SPRING)
- SANDWICH TYPE LEAF MADE OF GALVANIZED STEEL AND ROCK WOOL (150 KG/MC)
 LEAF FINISHING: PVC PRE-COATED FOIL OR GALVANIZED STEEL + PLASTIC FOIL.
- LEAF PERIMETER BAND WITH THE SAME FINISHING OF DOOR FRAME.
 LEAF THICKNESS: 42MM
- SUITABLE FOR ANY TYPE OF LOCK

THE PICTURES ARE FOR SALE PURPOSE ONLY.
 THE COMPANY IS ALLOWED TO CHANGE THE PRODUCT FEATURES WITHOUT ANY COMMUNICATION.