



# FALSE CEILING STAVES C rated class 300GS-A



Certificato N° 8405/03/5

**STAVES FOR C RATED CLASS FALSE CEILING MADE OF BENDED STEEL FOIL AND ROCK-WOOL (DENSITY 140 KG/MC)**

**AVAILABLE SURFACE FINISHING:**

- **PVC PRE-COATED GALVANIZED STEEL FOILS (ACCORDING TO LAMPRE COLOR SERIE)**
- **GALVANIZED AND VARNISHED STEEL FOILS (ACCORDING TO RAL COLOR SERIE)**
- **PREVARNISHED ALUMINIUM FOILS, RAW OR ANODIZED.**

**NARROW JOINT SHAPE (LOOK AT THE DETAIL IN THE DRAWING BELOW).  
STAVES MAX. LENGHT: 2500 MM. WIDTH 300 MM (MAX).**

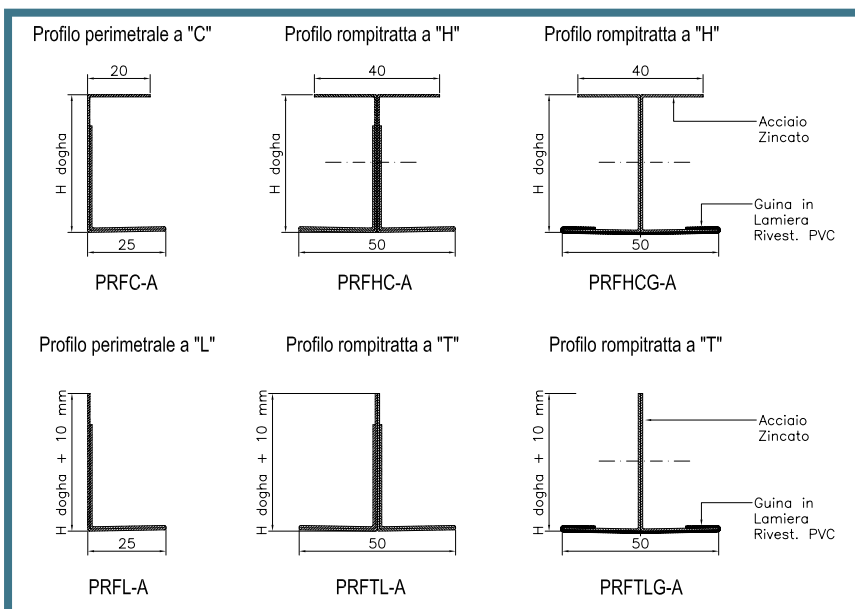
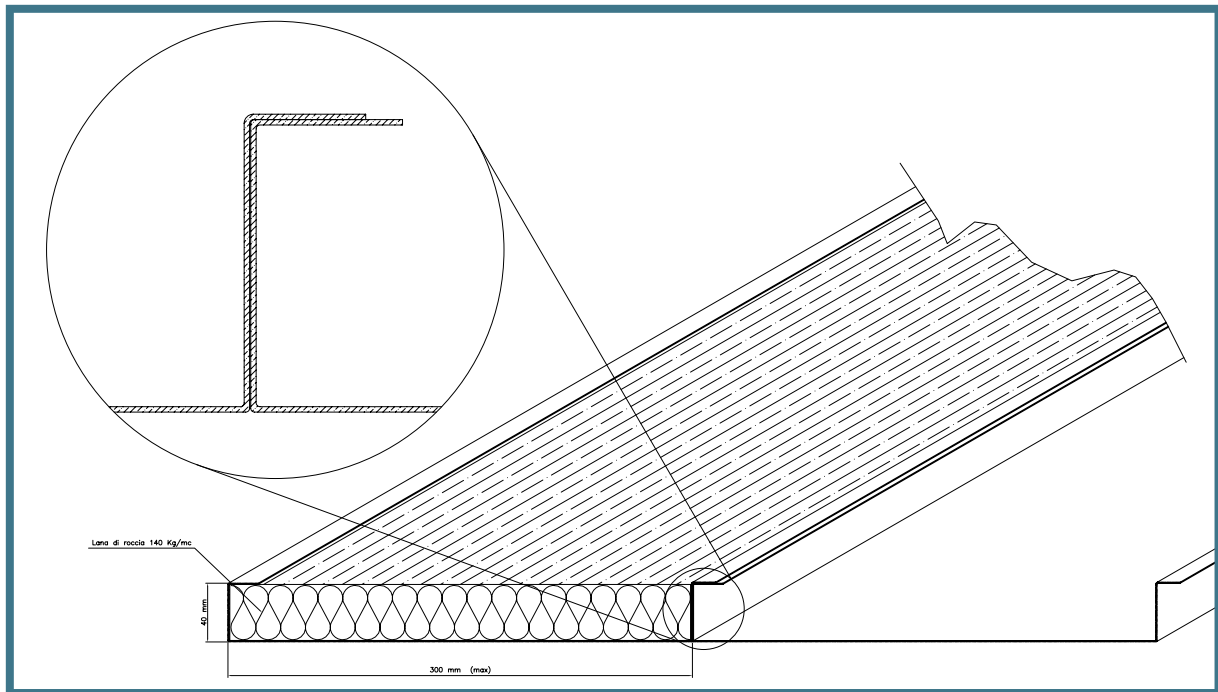

300GS-A  
PRFC-A  
PRFHC-A  
PRFHCG-A

PRFL-A  
PRFTL-A  
PRFTLG-A

STAVE DIMENSIONS W300xL2500 MM (MAX.)

PERIMETER SUPPORT SHAPE TYPE "C"  
INTERMEDIATE SUPPORT SHAPE TYPE "H"  
INTERMEDIATE SUPPORT SHAPE TYPE "H" WITH PVC SHEATH  
PERIMETER SUPPORT SHAPE TYPE "L"  
INTERMEDIATE SUPPORT SHAPE TYPE "T"  
INTERMEDIATE SUPPORT SHAPE TYPE "T" WITH PVC SHEATH